

The **flush-mounted electric shutter controller SB-ROLL** is a cutting edge product of the **MASTER Smart Home** line, suitable for controlling and managing your home and business electrical shutters. Manage the opening and closing of your shutters wherever you are using your smartphone, tablet or PC with the MASTER Smart Home app. Comfort, security and energy saving in a modern home. This user manual will help you install the “**MASTER Smart Home**” app for Android or iOS and enjoy the “smart” shutter control functions.

Features

- Visualization, control and management of electric shutters
- User-friendly, easy-to-use interface
- Works with the Google Assistant voice commands
- Secure connection to Wi-Fi
- No hub/gateway is required
- Time-schedules
- Maximum economy and comfort through smart scenes
- Low implementation cost in existing or new installations
- Automatic detection of motor terminal switches
- Detection of intermediate position of the roll

Control: Remotely via Wi-Fi and Internet with the “MASTER Smart Home” app for smartphone, tablet and PC and locally, via button (Open/Pause/Close) with instant push.

Technical Specifications

SHUTTER CONTROLLER	MOTOR CONTROLLER AC
OPERATING VOLTAGE	180 - 230V DC
OPERATING FREQUENCY	50Hz
OUTPUT POWER	1150W / 5A MAX
STAND BY CONSUMPTION	≤ 1W
TEMPERATURE CONDITIONS	- of operation: -20°C to +50°C - of storage: -20°C to +60°C
WIRE SIZE	0.5 mm to 3.5 mm
MOUNTING	Electrical switch box min. 40mm

CE This product complies with the requirements of the following EU Directives: 2014/30/EE (EMC), 2014/35/EE (LVD)

This product should be disposed of in accordance with national laws and environmental protection requirements



ELECTRIC
SHUTTER
CONTROLLER

SB-ROLL



Works with
Google Assistant
voice commands

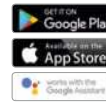

Draft of Electrical Installation

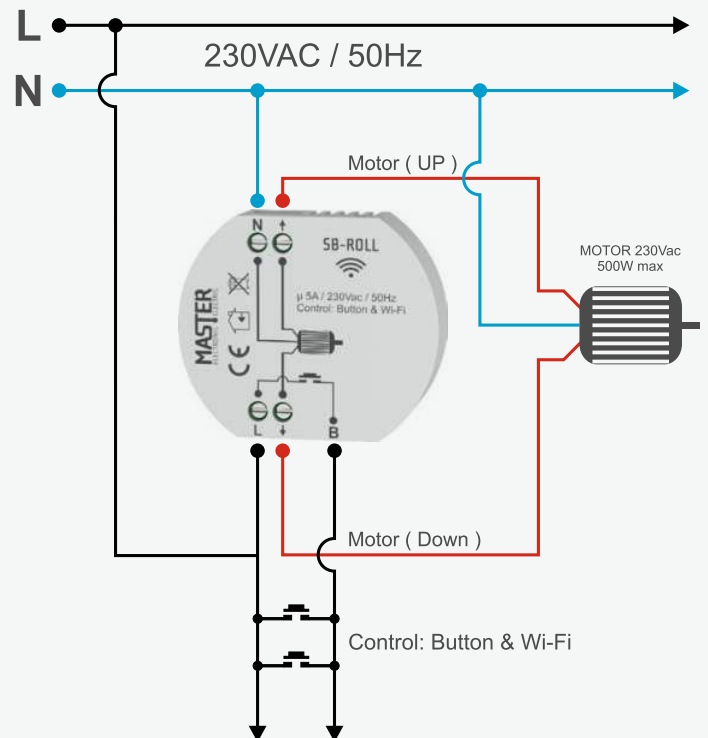

Create a User Account

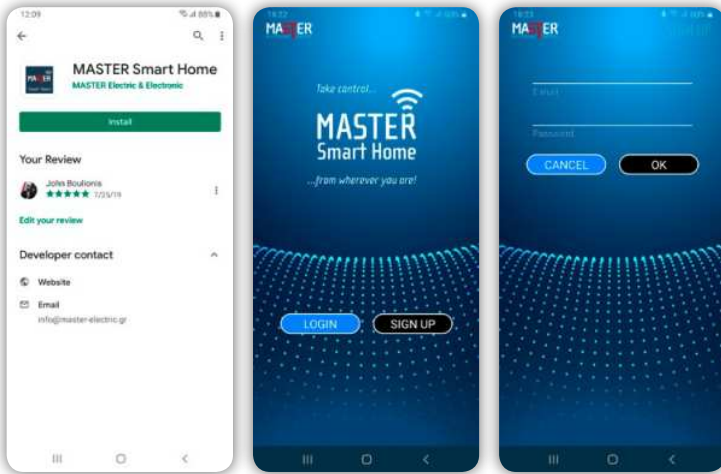

Step 1

Step 2

Step 3

Download the «MASTER Smart Home» free app and create an account.

Step 1

Download the “MASTER Smart Home” application from Google Play or the App Store.

Step 2

Launch the application and tap “SIGN UP”.

Step 3

Enter your credentials, tap “OK” and follow the instructions in the activation email you received.

Create a Location

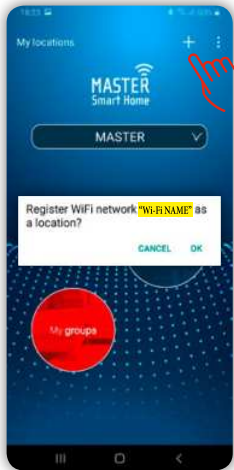

Step 4

Create easily and quickly different locations for the office or home.

* First, make sure your Smartphone or Tablet is connected to your local Wi-Fi network.

Step 4

Sign in to the “MASTER Smart Home” application and press “+” to create your location.

* The name of the location that originally appears, is the name of your wireless local Wi-Fi network.

New Device Connection

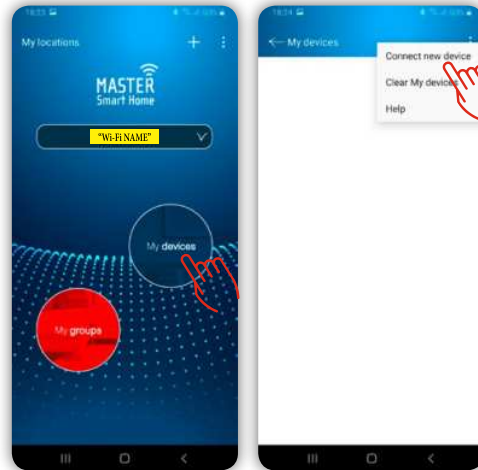

Step 5

Step 6

Create easily and quickly different locations for the office or home.

Step 5

From the app homepage, select “My Devices”.

Step 6

Press “ : ” and select “Connect a new device” from the popup window.

New Device Connection

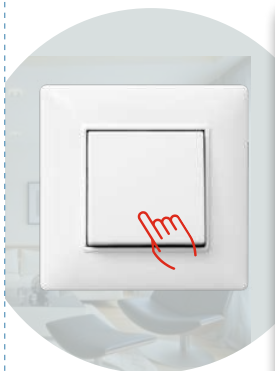

Press the control button that is connected to the SB-ROLL, 10 times repeatedly

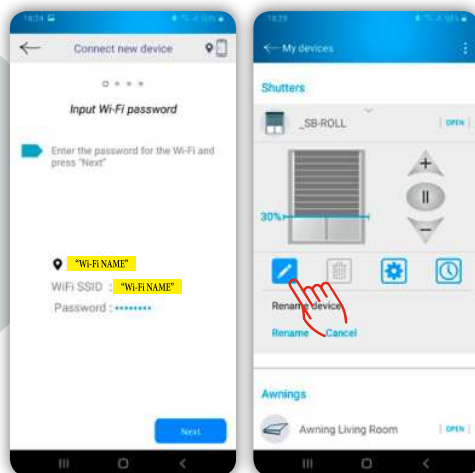

Step 7

Step 8

Step 7

Press 10 times repeatedly the control button that is connected to the SB-ROLL rolling shutters controller and follow the instructions in the «MASTER Smart Home» application.

* The “SSID” field automatically displays the name of your Wi-Fi network.

Step 8

The SB-ROLL rolling shutters controller, after its successful connection, appears in «My devices». Select the connected controller to operate or configure it.